

A PORTION OF SEC. 27, T 18 N., R 18 E., W.M.

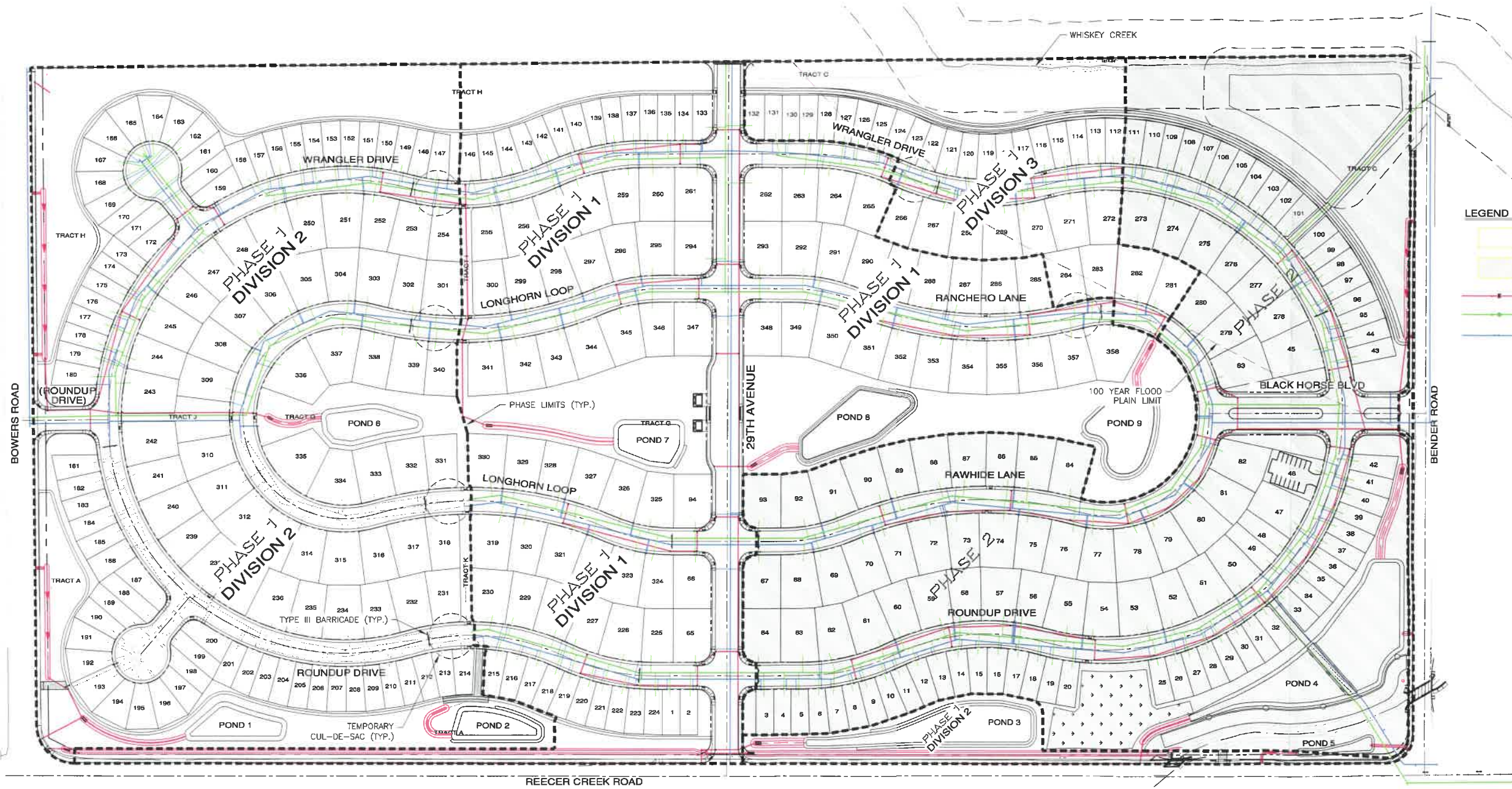
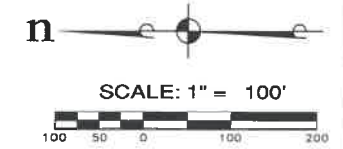

LEGEND

	PHASE 1
	PHASE 2
	STORM LINE
	SEWER LINE
	WATER LINE

REVISIONS			
NO.	DESCRIPTION/DATE	BY	

ESM CONSULTING ENGINEERS, LLC
 35400 8th Ave S, Suite 205
 Federal Way, WA 98003
 www.esmcivil.com

TREVOR L. STIFF
 LICENSED PROFESSIONAL ENGINEER
 43334
 0237 839-4113
 0425 297-8900

Civil Engineering
 Public Works
 Land Surveying
 Project Management
 Land Planning
 Landscape Architecture

D.R. HORTON
BLACK HORSE AT WHISKEY CREEK
 KITTITAS COUNTY WASHINGTON

RECEIVED
 APR 13 2018
 Kittitas County CDS

JOB NO.:	410-028-005
DWG. NAME:	EN-83
DESIGNED BY:	TLS
DRAWN BY:	CJR
CHECKED BY:	
DATE:	04/12/2018
DATE OF PRINT:	
EN-83	
1 OF 1 SHEETS	

File: \\Esm\ENR\ESM-085\410-028\028\exhibit\A\EN-83.dwg
 Plotted: 4/12/2018 3:29 PM
 Plotted By: Curt Roberts